

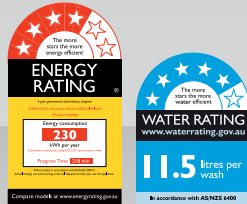

WDBU3I4PIXAU

60CM 14 PLACE SETTING BUILT-UNDER DISHWASHER



FEATURES & BENEFITS



BUILT-UNDER DESIGN

Perfectly fits beneath your counter top providing a sleek, integrated look seamlessly in the kitchen space!



SPACECLEAN 3RD RACK

Fit even full-size bowls, glasses and mugs into the large and deep 3rd rack with powerful integrated water jets, effortlessly load and clean thoroughly!



6TH SENSE TECHNOLOGY

With 6th sense technology, it automatically senses how dirty the dishes are and adapts the cycle time and water pressure accordingly. It ensures to provide the perfect performance with water, energy & time saving.



POWER CLEAN PRO

Powerful water jets on the rear of the machine work to deliver supreme cleaning results on the toughest soil.



HALF LOAD

If there are not many dishes to be washed, a half loading may be used in order to save water, electricity and detergent.



SANITISATION

Thanks to Sanitisation option, it could eliminates 99.999% bacteria and provide more HYGIENE experience



NATURAL DRY

The automatic door opening at the end of the program ensures better and more natural drying. This system guarantees higher energy efficiency and better drying results.

TECHNICAL SPECIFICATIONS

TYPE	Built-under
COLOUR / FINISH	Stainless Steel
DISPLAY	LED Display
CONTROL	Touch UI
CAPACITY	14 place settings
NET WEIGHT	37.5kg
PRODUCT DIMENSION	W 600mm x H 820mm x D 590mm
PROGRAMMES	Eco, Auto Intensive, Auto Mixed, Auto Fast, Crystals, Rapid, Prewash, Selfclean
FEATURES	6th Sense, Power Clean, Half Load, Sanitization, Natural Dry, Removable large SpaceClean 3rd rack, Removable upper rack with double cup shelves and rubber mat for glass protection, Removable Lower rack with Pan holder Dual Inverter, 14 Place Setting
SAFETY	Aquastop
WATER RATING	5.0 stars rating
ENERGY RATING	4.0 stars rating
ACCESSORIES	Inlet & Outlet Hose
VOLTAGE	220 - 240V
CURRENT	10 amp
PLUG TYPE	Australian plug
NOISE LEVEL	43dB
LENGTH OF HOSE	Inlet: 155cm Outlet: 150 cm
LENGTH OF ELECTRICAL CORD	130cm
PACKAGING DIMENSION	W 625mm x H 880mm x D 675mm
GROSS WEIGHT	40KG
WARRANTY	5 years parts and labour

DISTRIBUTED BY ARISIT PTY LTD

40-50 Mark Anthony Drive, Dandenong South VIC 3175
Ph: 1300 762 219 Fax: 03 9768 0838 Website: www.arisit.com

INSTALLATION GUIDE

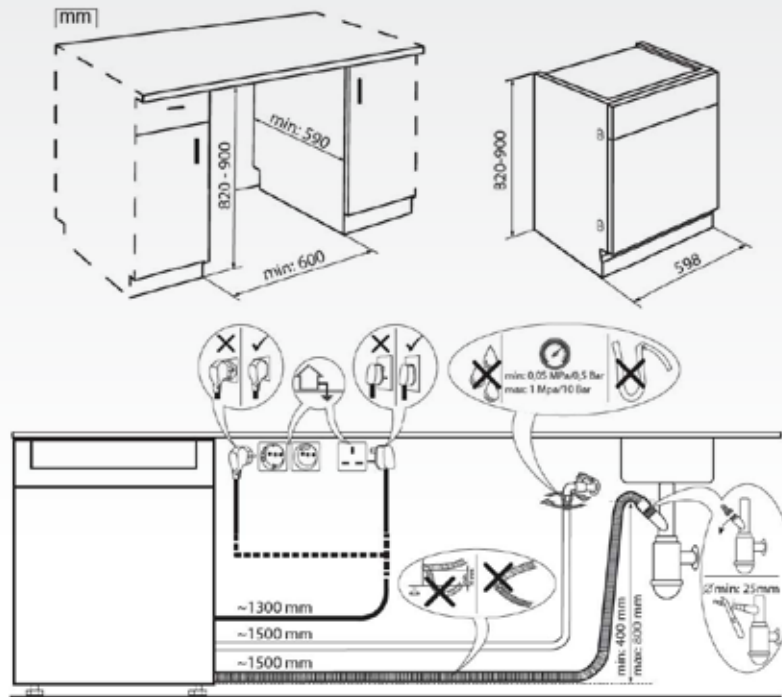

CONTROL PANEL

